

SOLDERING IRONS [TEMPERATURE-CONTROLLED STATIONS]

TEMPERATURE-CONTROLLED SOLDERING STATIONS

TEMPERATURE-CONTROLLED SOLDERING STATIONS
MINI SOLDERING STATIONS
SOLDERING CONTROLLERS



Lightweight, slim handpiece
with reduced heat-up!

TEMPERATURE-CONTROLLED SOLDERING STATIONS RX-701AS/RX-711AS



New Soldering Iron Stand
More stable, better operation

Quick Heat Recovery

New heater with internal sensor achieves 60 W.

Easy to Use

Allows two-tiered setting with another RX-701AS/711AS.

High Insulation. Reliable 24 V Output.

The heater is completely separated from the input power by the insulated transformer. And the 24 V heater is safe to use for sensitive components.



RX-711AS



RX-701AS

Comfortable Handpiece **Protective Cover (PAT.)**
We have made it slimmer while still achieving less heating of grip. Prevents tampering.

INCLUDED



REPLACEMENT PARTS / OPTIONS

Heater RX-72H	Spacer RX-72SS
Heater Barrel RX-72HP	Iron Unit RX-72GAS
collar TQ-77NUT	

REPLACEMENT TIPS

Wide Variety of Tips

A wide variety of replacement tips for all types of work. Refer to page [p.30](#) for further details.

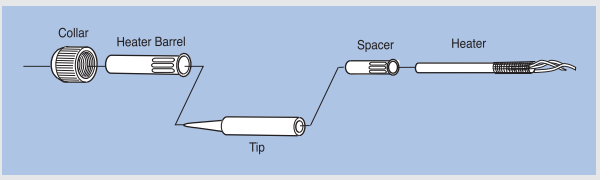
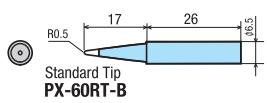

TIP-TEMPERATURE RECOVERY FEATURES

Solder melted consecutively on 5x5mm land. Approx. 2 s / land. (with **PX-60RT-B** tip)

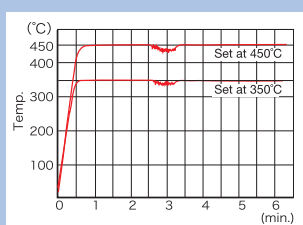

SPECIFICATIONS

Model	RX-701AS	RX-711AS
Voltage	110 V, 120 V, 220 V, 230 V, 240 V AC 50/ 60 Hz	
Power Consumption	65 W	
Power Cord Length	1.2 m	
Temperature Setting Range	200–450°C	200–480°C
Ripple Temperature	±5°C (unloaded)	
Insulation Resistance	Over 100 MΩ (500 V DC)	
Accessories	Soldering Iron Stand (ST-27), Soldering Iron Tip (PX-60RT-B)	

Control Unit	
Output Voltage	24 V AC
Dimensions	115 (W) × 98 (H) × 146 (D) mm
Weight	1.5kg

Soldering Iron Unit	
Voltage / Consumption	24 V AC / 60 W
Ground Resistance	2 Ω or less
Leak Voltage	Less than 2 mV
Heater	Ceramic heater
Cord Length	1.2 m
Length	197 mm (with PX-60RT-B)
Weight	44 g (with PX-60RT-B)

*The length does not include the cord bushing. The weight does not include the cord.

Equivalent to IPC/EIA J-STD-001C